

## PARTS (NOT TO SCALE)

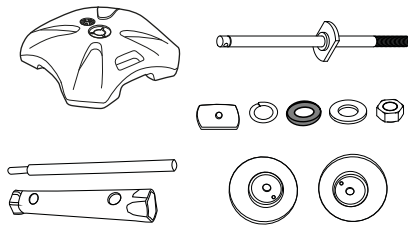

## ASSEMBLY OF BOX SPANNER

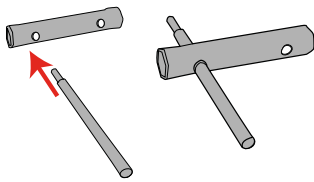

## TOOLS REQUIRED



## FOR ATTENTION

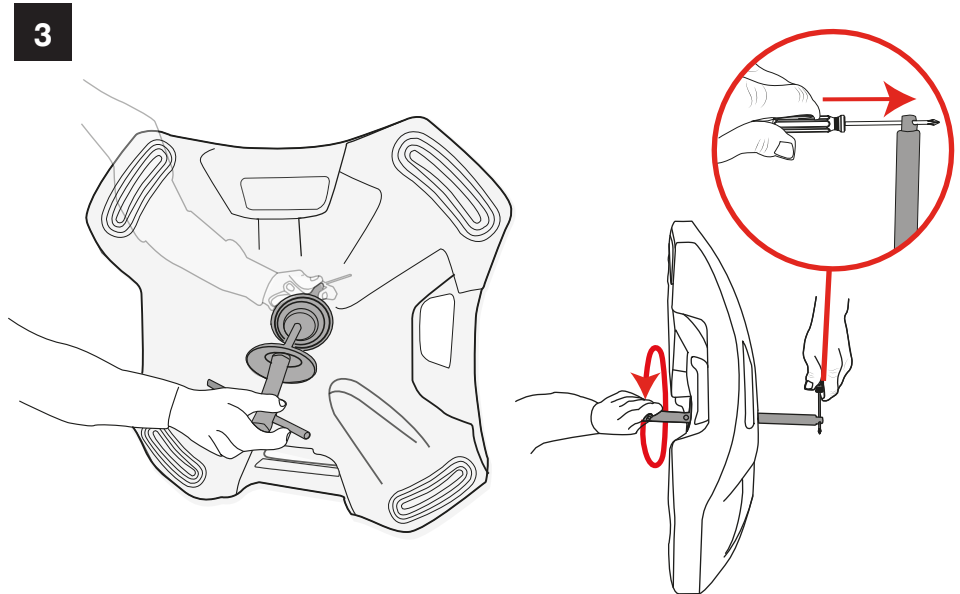
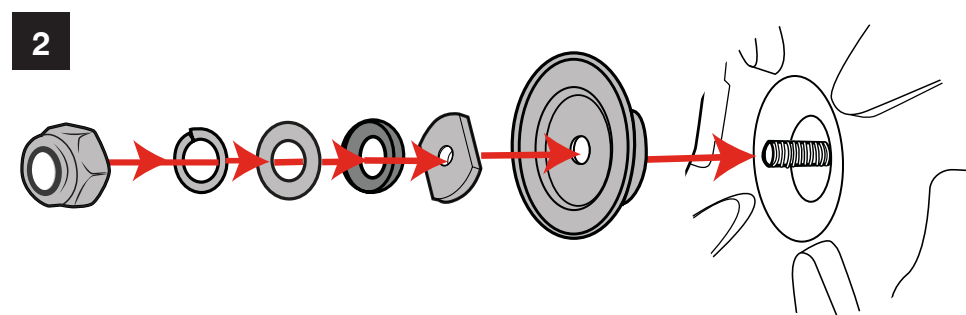
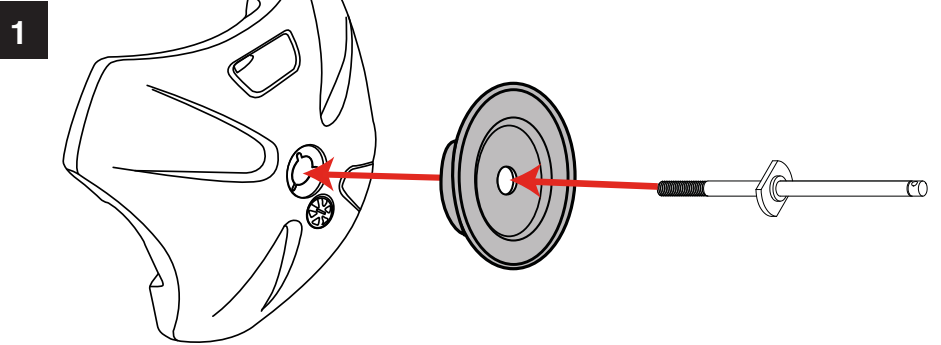
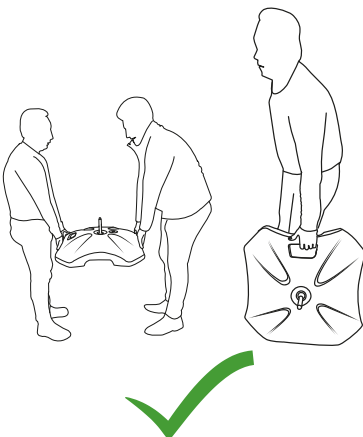

**NOTE: USE SCREWDRIVER AND BOX SPANNER TO TIGHTEN SPIGOT**

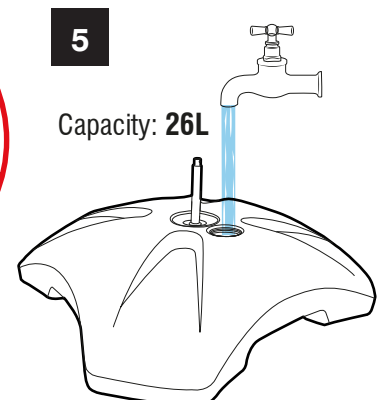
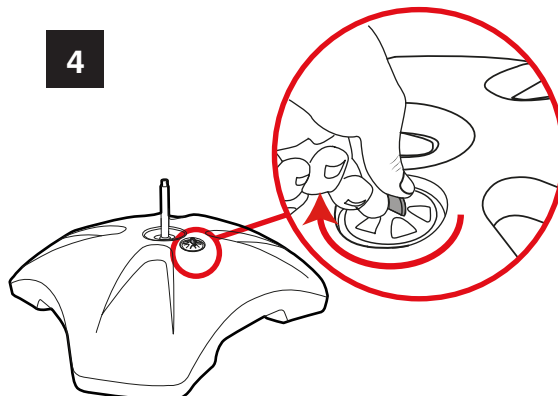

6

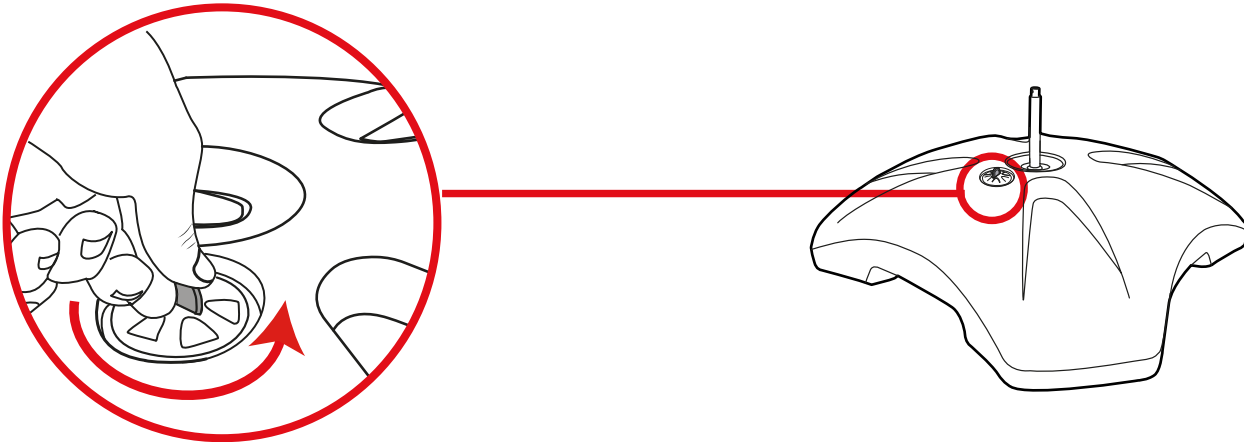

**NOTE: TIGHTEN WITH A COIN**



### STACKING THE BASES

7

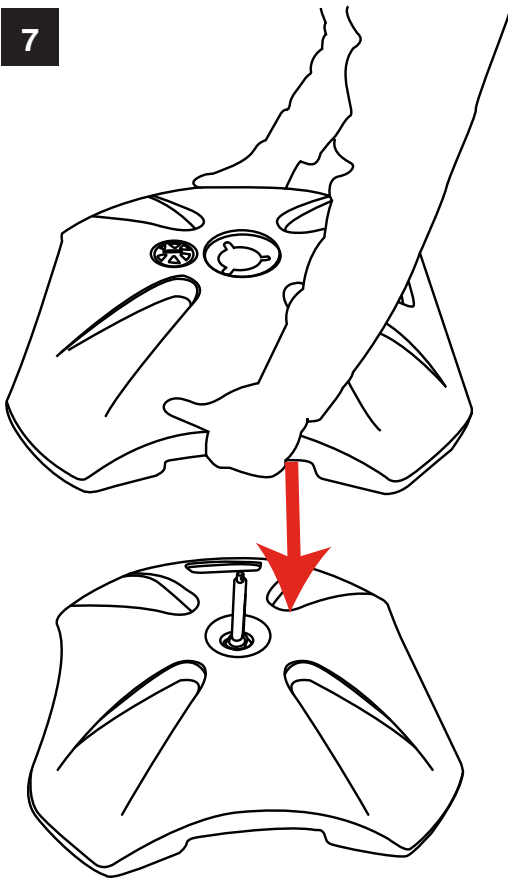

8

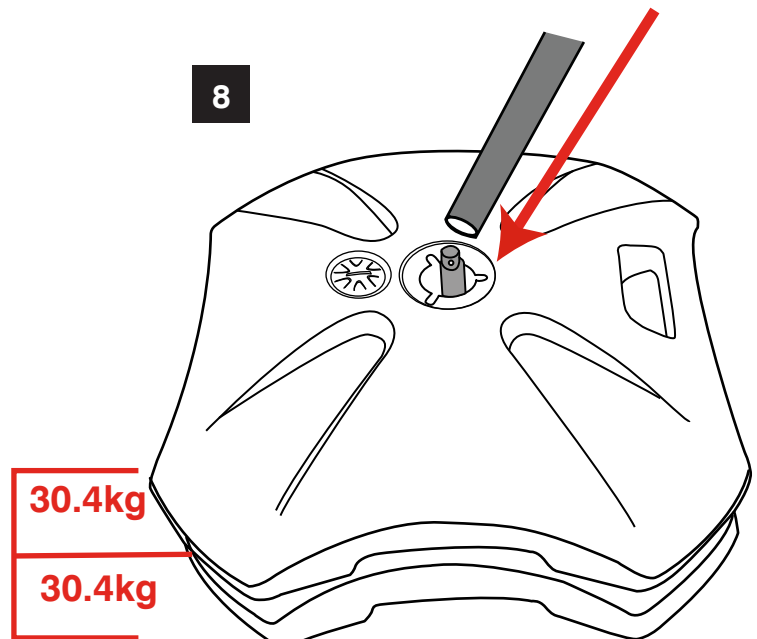

**TOTAL WEIGHT UP TO 60.8KG**